

## INSUL-HOLD COILS

### Installation Instructions (Horizontal Installation)

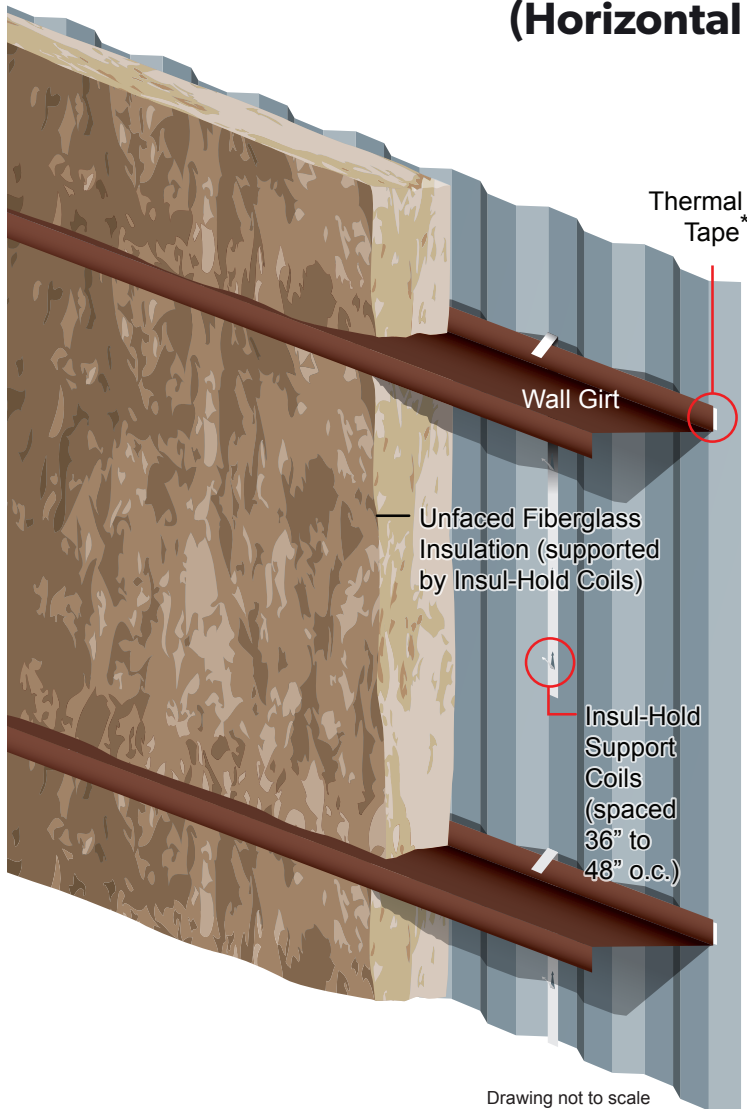

#### Step 1:

Cut 36" pieces of Insul-Hold and crimp to the outer flange of the wall girts. These should be placed with the arrows pointing up - spaced at 5' on center.

#### Step 2:

Bend the arrows inward at a 45 degree angle.

#### Step 3:

Prepare pieces of insulation to fit the dimension from girt to girt and impale it onto the Insul-Hold arrows for support.

\* 1/4" x 3" Thermal tape typically used with Energy Saver Walls, 1/8" x 3" Thermal Tape typically used on unfaced or liner panel walls.

**PLEASE CONTACT YOUR SILVERCOTE SALES REPRESENTATIVE  
FOR MORE INFORMATION AT (844) 232-3701 OR [INFO@SILVERCOTE.COM](mailto:INFO@SILVERCOTE.COM)**