

# **PURLIN**<sup>®</sup> **GLIDE FP**

INSULATION & LEADING EDGE FALL PREVENTION SYSTEM

FOR NEW CONSTRUCTION

# Silvercote™

A SERVICE PARTNERS COMPANY

**IF IT'S IMPORTANT TO YOU.  
IT'S IMPORTANT TO US!**

We strive to provide an exceptional customer experience on every order.

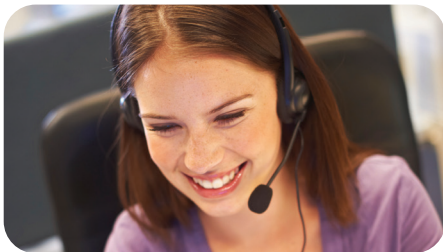

#### SALES AND TECHNICAL SUPPORT

- Customer Specific Support
- Building Code Experts



#### SERVICE

- Centralized Operations
- Energy Code Compliance



#### QUOTING TOOL

- 24/7 Online



#### RESEARCH AND DEVELOPMENT

- Silvercote Envelope Solutions
- New and Improved Systems and Accessories
- Customer Training

#### BEST IN CLASS MATERIALS

- Certified Formaldehyde Free Ecosse Technology



# OUR MISSION

Silvercote designs custom insulation solutions that create value for our customers, employees and shareholders. We empower our employees to deliver what we promise to drive success.



For more than 80 years Silvercote has partnered with customers in the metal building industry to provide innovative custom insulation solutions and systems.

Silvercote is part of the Distribution International (DI) family of companies. Founded in 1986 Distribution International is a value-added distributor of insulation-related specialty fabricated products, HVAC products, and safety supplies in North America.

Please contact us for more information (844) 232-3701 or [info@silvercote.com](mailto:info@silvercote.com)

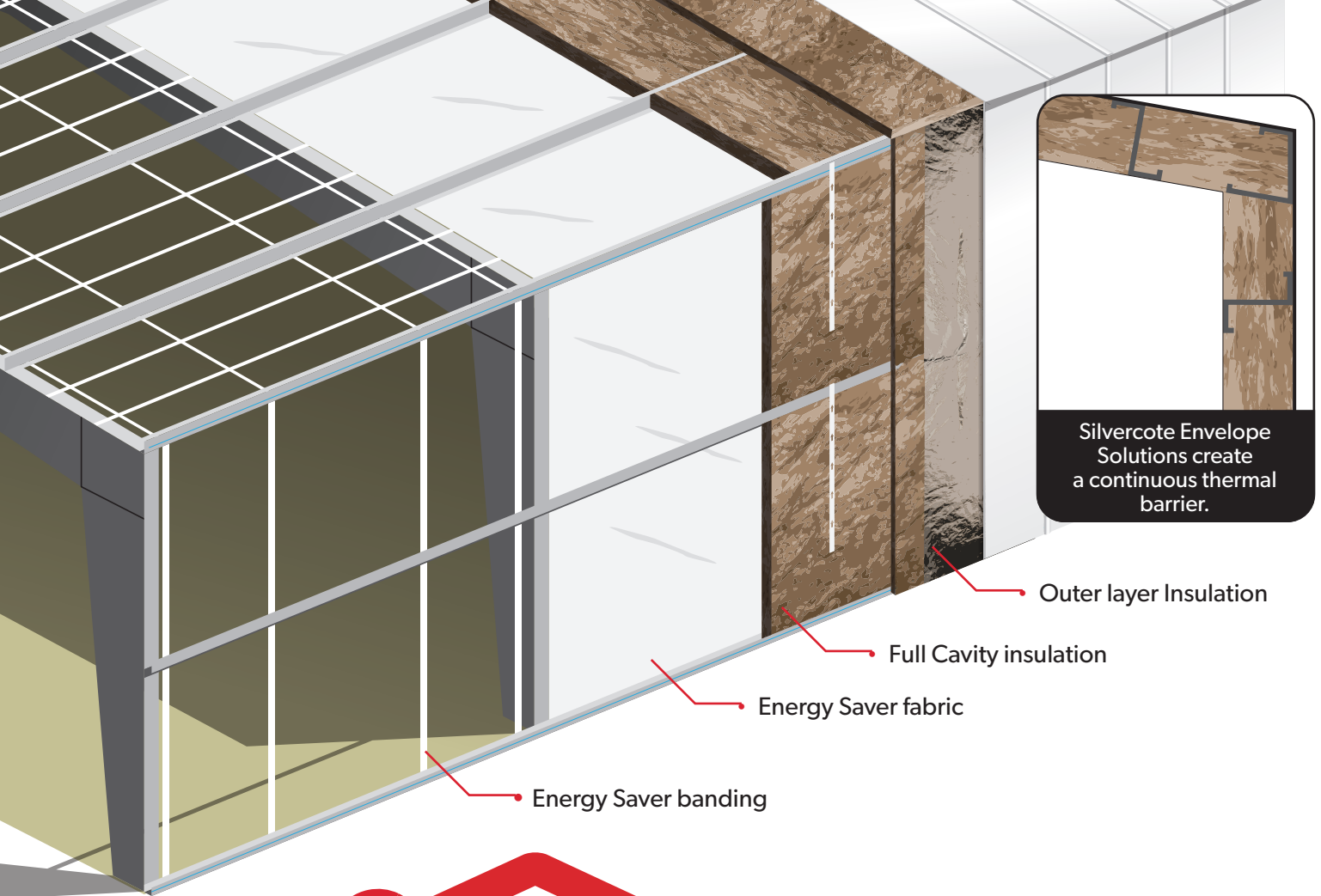

### Why Silvercote developed envelope solutions.

Industry wide challenges in meeting increasingly stringent building codes are the driving force behind Silvercote Envelope Solutions for Energy Saver™. Energy Saver is designed to provide optimal overall energy performance for your building.

We want to make complex building designs simple. We provide custom fabricated insulation and fabric, but also all necessary accessories and components to install your project correctly the first time.

We strive to provide customized insulation to meet for your specific project needs.

### Energy Saver is the optimal Silvercote Envelope Solution!

- Our premier system can meet or exceed IECC 2015 energy code requirements
- Provides a clean and finished appearance of roofs and walls by hiding the purlins and girts
- Improves acoustical performance compared to no insulation
- When installed to Silvercote's specifications provides a barrier to air leakage and contributes to a better airtight building
- Silvercote's fabric welding technology creates a continuous single custom sized fabric

## What is Energy Saver?

Energy Saver can provide our highest R-value roof and wall envelope insulation system for new construction. It consists of a network of banding straps, a bright interior support fabric and unfaced ECOSE® glass mineral wool insulation creating a total building envelope. The Energy Saver system is designed primarily for use in metal buildings, but can also be used in the roof and wall for other types of building construction.



Energy Saver FP provides OSHA-compliant leading edge fall protection. The roof system fabric is installed under the roof secondary structure and is supported by a banding grid system. ECOSE glass mineral wool insulation is installed in varying thickness between and across the purlins to obtain the desired insulating values.

The Energy Saver wall system is offered in a single or double layer ECOSE glass mineral wool insulation system. Fabric is installed in the interior resulting in a bright finished wall appearance.

## Improve productivity

71 percent of office workers list noise as a key impediment to productivity. In fact, noise pollution is a major environmental problem and exposure to excessive noise causes stress, poor concentration, productivity reduction, fatigue and loss of psychological well-being. ECOSE glass mineral wool insulation in walls, ceilings, floors and ducts significantly reduces the amount of noise inside buildings.

Use Energy Saver Envelope in:

- Manufacturing facilities
- Aircraft hangers
- Sports arenas
- Retail locations

Insulation products, specifically wall and ceiling insulations also reduce noise transfer from one room to another.

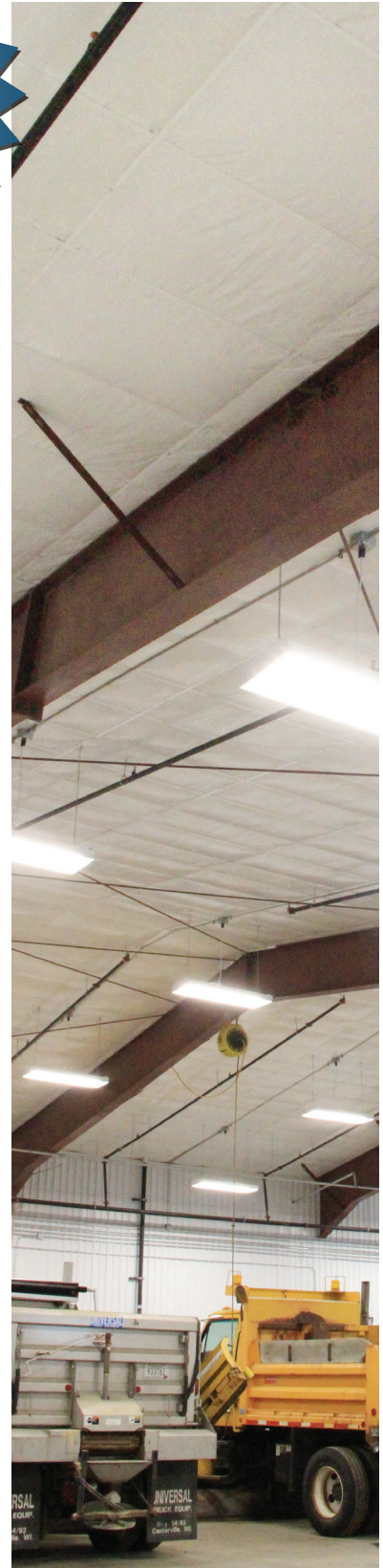



# PURLIN GLIDE FP

INSULATION & LEADING EDGE FALL PREVENTION SYSTEM

## OSHA-compliant leading edge fall protection for roofs

The Purlin Glide FP system meets OSHA requirements for leading edge fall protection. To meet OSHA guidelines an insulation support and fall protection system must restrain and support 400 pounds dropped from at least 42" above the system. The Purlin Glide FP system passes this rigorous test! Go to [silvercote.com](http://silvercote.com) to view OSHA's review letter.



### Tensile strength testing –

We conduct daily testing on actual production samples of welded Purlin Glide FP fabric to ensure your safety. Production samples must exhibit a seam strength of more than double the required failure strength to meet our standards and be considered acceptable for use in our roof Purlin Glide FP system.

### Straight Welds –

The Purlin Glide FP fabric is laser aligned and vacuumed into place prior to being hot-air compression welded. Precision winding results in square, tight and easy to unwind rolls.



### Minimal seams & increased productivity

Fabric rolls in widths up to 27' and lengths up to 210' allow for increased productivity by reducing seams up to 70% compared to conventional faced metal building insulation. Our fabric roll overlap does not require any staples or tape. Longer lengths can be requested and will be evaluated at the time of production.

### Lightweight equipment & quick set-up time

Lightweight, well-maintained equipment and wide fabric rolls make the set-up quick and easy. The provided layout sheet takes the guesswork out of equipment and fabric roll placement.

**PROVIDES**



**Bright Clean Finished Appearance**



**Vapor Retarder**



**Formaldehyde Free**



**Excellent Acoustic Properties**



**Custom Sized Fabric & Insulation**



**Air Tightness**

**OSHA - compliant leading edge fall protection (over the purlin) roof system that provides high R-value with speed of installation, including bar joist**

- Allows flexibility under adverse weather conditions
- Greatly reduces visible seams compared to faced blanket
- Lightweight equipment and quick setup-time
- Our Purlin Glide FP fabric welding process produces seams that exceed the ASTM D-751 Standard of the fabric itself
- Great solution for a high eave building
- Free online, Purlin Glide Fall Prevention system training available

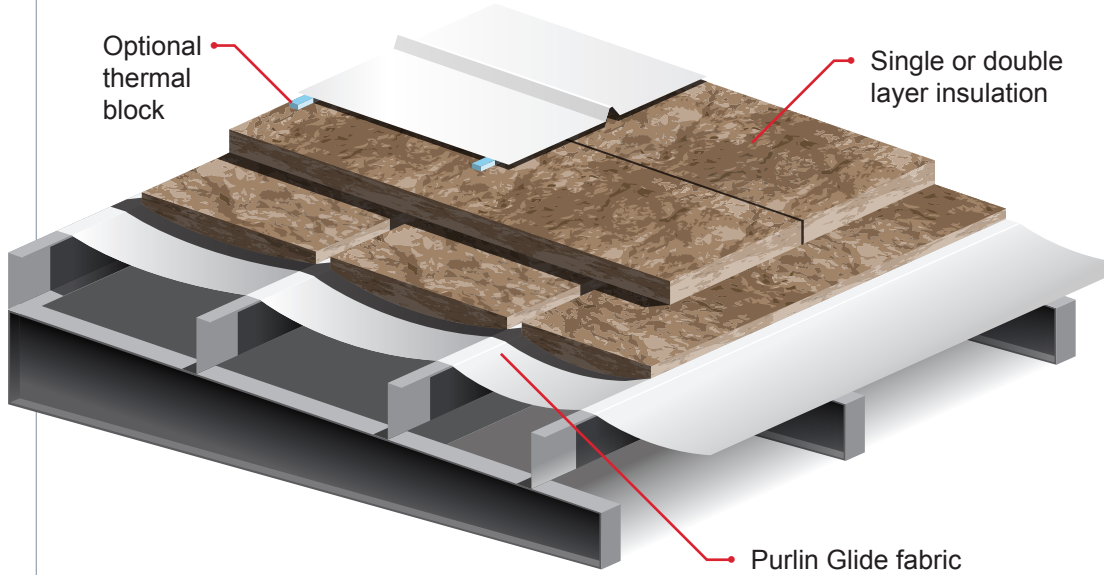

## ECOSE glass mineral wool insulation

Our glass mineral wool insulation is available with ECOSE Technology binder. ECOSE Technology insulation products deliver the same exceptional quality, handling and durability you have come to expect and is Formaldehyde Free! It is certified to the toughest indoor air quality certification in the industry - GREENGUARD Gold - and is certified to meet CHPS Low-Emitting Materials criteria section 01350.



### SINGLE LAYER SYSTEMS

R-value	Nominal Thickness
R-8	2 <sup>5</sup> / <sub>8</sub> "
R-10	3"
R-11	3 <sup>1</sup> / <sub>2</sub> "
R-13	4"
R-19	6"
R-20	6"
R-25	8"
R-30	9 <sup>1</sup> / <sub>2</sub> "

### DOUBLE LAYER SYSTEMS\*\*

R-value	Thickness	Configuration
R-20	6" Double Layer	(R-10 + R-10)
R-23	7" Double Layer	(R-13 + R-10)
R-26	8" Double Layer	(R-13 + R-13)
R-29	9" Double Layer	(R-19 + R-10)
R-30	9 <sup>1</sup> / <sub>2</sub> " Double Layer	(R-19 + R-11)
R-32	10" Double Layer	(R-19 + R-13)

## FABRIC SPECIFICATIONS

**PURLIN GLIDE FP** fabric is cross-woven reinforced high-density polyethylene yarns coated on both sides with a continuous white or colored polyethylene film. This material is manufactured in custom-fit rolls by hot-air compression welding. Rolls are fabricated to fit the building's secondary steel layout and allow for rapid installation.

The standard color is white; however, additional colors are available on a non-standard basis (minimum order size and lead time will vary). Purlin Glide FP fabric can be cleaned with a mild dishwashing detergent; chemical cleaners should be avoided.

<b>Coating Thickness</b>	1.75/1.1 mil average
<b>Weight</b>	3.4 oz. per square yard
<b>Tensile Strength</b>	115 lbs. warp x 65 lbs. weft (ASTM D 5034)
<b>Tongue Tear</b>	22 lbs. warp x 18 lbs. weft (ASTM D 2261)
<b>Puncture Resistance</b>	43 lbs. (ASTM D 4833)
<b>Permeance</b>	0.02 (ASTM E 96 A&B)
<b>Light Reflectance</b>	>80% (ASTM E 1347)
<b>Mullen Burst</b>	165 psi (ASTM D 3786)
<b>Flame Resistance</b>	Flame Spread - 10 Smoke Developed - 30 (ASTM E 84 & UL 723)
<b>UV Weathering</b>	UV stabilizers added for extra protection

**Note:** These are manufacturer supplied property values and are intended as guides only. The figures listed do not represent specification minimums or limits.

The Purlin Glide FP system provides OSHA-compliant leading edge fall protection when installed according to the manufacturer's specifications by a Silvercote certified installing contractor. See Silvercote's Purlin Glide FP Contractor Agreement for complete details.











**Please contact your Silvercote Sales Representative  
for more information at (844) 232-3701 or [info@silvercote.com](mailto:info@silvercote.com)**