

## BANDING SYSTEM for Bar Joist

One of the most popular high R-value insulation systems used in metal building construction is the Banding System. This is an easily installed, attractive system which requires very little hardware. The typical bar joist installation consists of white banding which is positioned within the joist space approximately 9" beneath the roof panel (depending on system R-value). Proper location of the banding is very important as most industry experts believe that air spaces within a fiberglass system should be avoided in order to properly control condensation. The banding is used to support a layer of faced blanket insulation that is positioned parallel to the bar joist. An additional layer of unfaced insulation is positioned above the bar joist at the time the roof panels are being installed.

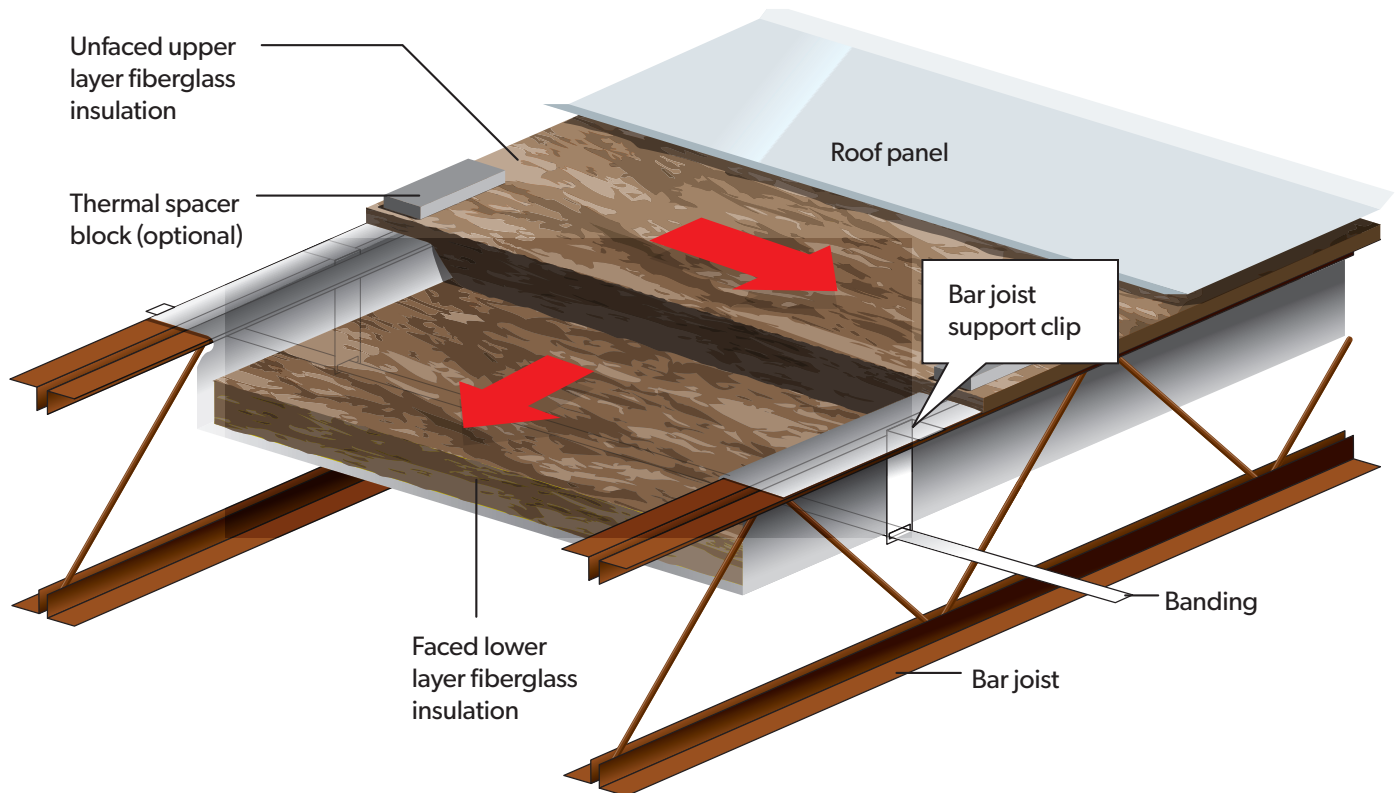

## Banding System for Bar Joist Application Installation Instructions

**Step #1:** Drop the “L” shaped Bar Joist Support Clip through the center of the joist (or on the outside of the joist in the case of a closed flange).

**Step #2:** Install 1” white steel banding through the slot at the bottom of each clip. Typically the clips and banding are installed 30” on center.

**Step #3:** Faced blanket insulation is specifically fabricated to fit between each pair of joists and is typically produced in rolls that equal 1 bay length (plus 12” extra for stretching/handling). These rolls are un-wound and positioned within the bar joist space and are supported by the banding. It is important that the tabs (the facing material that is laminated to the lower fiberglass layer is wider than the glass – this extra material is called a “tab” or “tabs”) are pulled up and over the joists. These tabs should either be rolled and stapled together, or sufficiently overlapped in order to achieve a consistent vapor retarder. If overlapped, place a small piece of tape (every few feet or so) on the tabs so they don’t separate as the top layer of insulation is positioned.

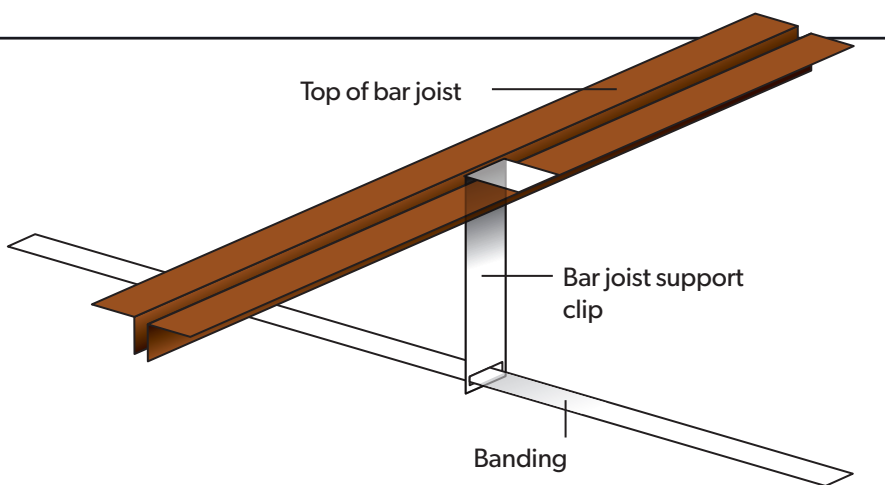

**Step #4:** End to end connection of the rolls (above each frame line) can be achieved by peeling back a small amount of the fiberglass and then stapling the exposed facing from one roll to the next or by taping the ends of each roll to the top of the rafter (depending on the specific construction details). Some erectors prefer to run a TEK screw with a washer through the insulation into the rafter for additional support. A similar approach can be used at the ends of the buildings where the exposed facing should be taped to the rake angle.

**Step #5:** Position the unfaced fiberglass layer perpendicular to the bar joist - on top of the tabs and faced insulation. Optional thermal blocks can be used where applicable. Once this step is complete, the roof panels can be installed above the insulation.

**Note:** It is suggested that you check for mid-span bracing and other obstructions when selecting a high R-value system, as they may compromise thermal performance and vapor retarder integrity depending on their location. Some systems are much better choices than others when bracing exists. Not recommended for high moisture applications such as swimming pools, fish hatcheries, indoor greenhouses, indoor water parks, waste treatment facilities, wash bays etc. These installation recommendations do not address the suitability of our products for any particular application or intended use and operation of any facility. Please consult a local engineer/experienced design professional familiar with your application to ensure the assemblies of the building envelope and the HVAC work together properly as a system.

**If you have any questions, please contact your Silvercote sales representative or send an email message to us at: [info@silvercote.com](mailto:info@silvercote.com)**

**PLEASE CONTACT YOUR SILVERCOTE SALES REPRESENTATIVE  
FOR MORE INFORMATION AT (844) 232-3701 OR [INFO@SILVERCOTE.COM](mailto:INFO@SILVERCOTE.COM)**