

# SINGLE LAYER WALL APPLICATION

GBP Silvercote's Energy Saver FP™ System provides a high R-value insulation system with a superior finished appearance compared to regular faced blanket methods. This system also maximizes thermal performance, as the entire girt cavity is completely filled with insulation. A bright interior finish is achieved through the installation of this durable, low maintenance system.

## INSTALLATION INSTRUCTIONS FOR SINGLE LAYER SYSTEM:

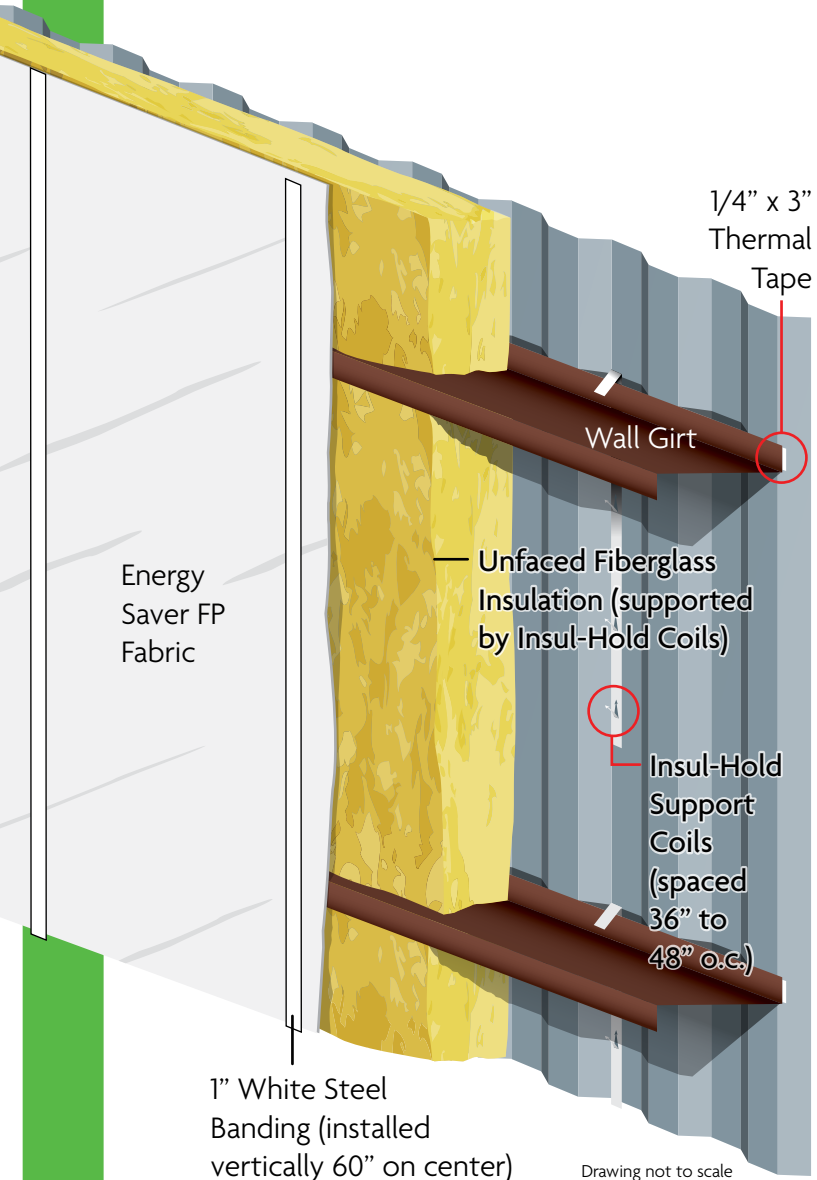

**Step 1:** Most Energy Saver FP wall systems are single layer applications of R-19, R-25 or R-30, depending on available girt depth. Apply 1/4" x 3" foam tape (a standard system component) to the exterior side of the girts (this is done during the sheeting process).

**Step 2:** Cut 24" pieces of Insul-Hold strap and crimp to the outer flange of the wall girts, approximately 36" to 48" on center, with the arrows pointing up. Bend the arrows inward at a 45-degree angle.

**Step 3:** Unfaced insulation is provided in roll widths of 36", 48", 60", or 72", depending on erector preference. Cut pieces of insulation to the girt space plus 1" for a tight fit. Place the insulation within the girt space and impale it onto the Insul-Hold arrows for support.

**Step 4:** Unwrap and position the Energy Saver FP fabric (which is custom made to fit each bay space) at floor level - taking special care to keep it clean. Deploy the fabric upward toward the eave and temporarily clamp it to the "on plane" strap described in step 6, below. Spread the fabric out over the entire bay and clamp where necessary to hold it in position.

**Step 5:** Install a series of vertical bands (an included system component) 60" on center from the eave strut to the base angle using the self-drilling fasteners included with the system. If the Energy Saver FP system was previously installed in the roof, it is recommended the bands be

**CONTINUED ON BACK.**

## INSTALLATION INSTRUCTIONS CONTINUED.

positioned in line with the cross bands from the roof system (for a detailed drawing of this visit [www.silvercote.com](http://www.silvercote.com)). Smooth out the fabric and install 12-14 TY3 3/4" self-drilling fasteners with 3/4" OD washers through the banding and fabric, into girts. Use the 3/4" x 98' Blue Transfer tape (included component) to adhere the fabric to the columns and base angles, making sure that the fabric is tight and smooth.

**Step 6:** Connection of the wall system to the roof system can be accomplished very easily, providing that care is taken when installing the roof strapping. Within the first purlin spaces (i.e., the eave spaces), one of the roof straps needs to be positioned "on plane" or directly above the inside flange of the girts. That band should be positioned underneath the roof cross bands. With the band in position, the wall fabric can be brought upward, wrapped around the band, and glued to the roof fabric. The last step is to screw the vertical wall strapping through the fabric, through the previously described roof strap, and through the roof cross band. You will need to bend the very end of the banding 90 degrees for it to meet the roof strapping at the proper angle.

NOTE: Optimal thermal performance is achieved with the Energy Saver FP™ System, as all the space within the purlin cavity can be completely filled with insulation.